



LEYTON CROSS ROAD WILMINGTON KENT
DA2 7AP
Guide Price: £575,000 - £600,000 | Freehold



Park Estates are delighted to offer this spacious period 3 bedroom semi-detached home, with a lovely outlook over Dartford Heath and situated very close to excellent transport links and sought after schooling. The property has a lot of interesting period features and comprises of lounge, dining room which opens into a spacious fitted kitchen with double doors to a large decking area, garden WC, three large bedrooms and a family bathroom. In addition the property has road parking for 2 cars and an aprox 100' rear garden. Your early viewing would be highly recommended.

Local Authority: Bexley
Council Tax Band: D

Energy Efficiency Rating			
Score	Energy rating	Current	Potential
92+	A		
81-91	B		
69-80	C		
55-68	D	62 D	87 B
39-54	E		
21-38	F		
1-20	G		



01322 553322

60-62 High Street, Bexley, Kent DA5 1AH

bexley@parkestates.co.uk
www.parkestates.co.uk

Leyton Cross Road, DA2

Approximate Gross Internal Area = 101 sq m / 1082 sq ft
Approximate Outbuilding Internal Area = 14 sq m / 156 sq ft
Approximate Total Internal Area = 115 sq m / 1238 sq ft

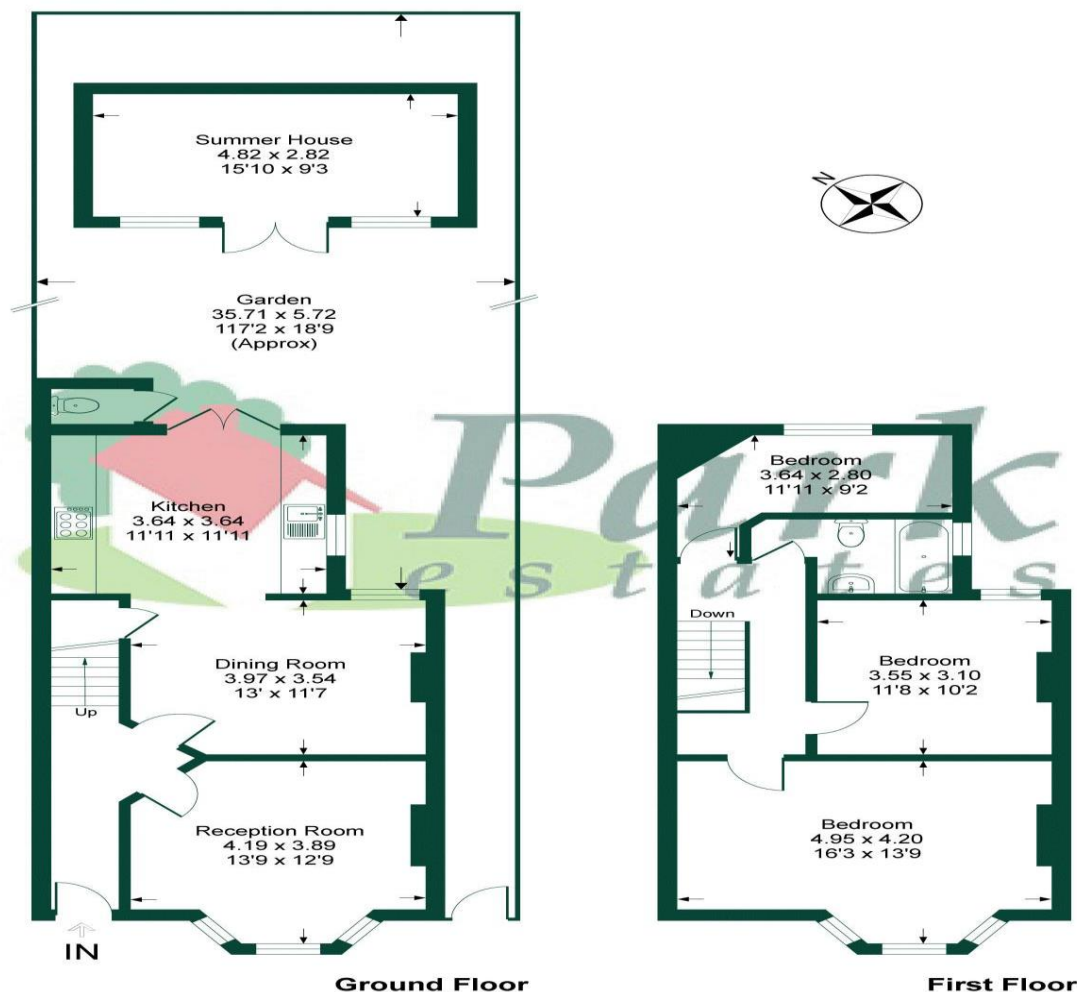

This plan is for layout guidance only. Not drawn to scale unless stated. Windows and door openings are approximate. Whilst every care is taken in the preparation of this plan, please check all dimensions, shapes and compass bearings before making any decisions reliant upon them.
Produced by Planpix

Every care has been taken with the preparation of details, but accuracy is in no way guaranteed. These particulars do not constitute a contract and are issued and accepted on the express understanding that all negotiations will be conducted through Park Estates. The seller does not make or give, nor do we or our employees have any authority to give a representation or warranty in relation to the property. Please contact this office before viewing the property. If there is any point which is of particular importance to you, we will be pleased to check the information for you and confirm that the property remains available. This is particularly important if you are contemplating travelling some distance to view the property. We would strongly recommend that all the information that we provide about the property is verified by yourself on inspection and also by your conveyancer, especially where statements have been made by us to the effect that the information provided by us has not been verified.